



KERJAYA HOTEL SDN BHD (667530-M)
A MEMBER OF KERJAYA PROSPEK GROUP

HEAD OFFICE

No. 1, Jalan Wangsa Permai
1st Floor, Bangunan One Wangsa
Taman Wangsa Permai
52200 Kuala Lumpur

TEL 603 6277 2666
FAX 603 6277 6222

MALACCA SALES GALLERY

189-G-01, Jalan Persisiran Bunga Raya
75300 Melaka Tengah, Melaka
FAX 606 282 0333

FOR ENQUIRIES, PLEASE CALL

606 282 2666

www.kerjayaprospek.com
sales@kpproperty.com.my

DEVELOPER LICENSE NO : 11775-1/11-2016/1400 | VALIDITY PERIOD : 18/11/2011-17/11/2016 | ADVERTISING & SALES PERMIT NO : 11775-1/2673/2012(12) | VALIDITY PERIOD 14/12/2011-13/12/2012 | TENURE OF LAND FREEHOLD. | APPROVING AUTHORITY : MAJLIS BANDARAYA MELAKA BERSEJARAH | BUILDING PLAN APPROVAL REF NO. : O3032/07/2010 (32). | EXPECTED DATE OF COMPLETION : OCTOBER 2014 | LAND ENCUMBRANCES N/A. | TOTAL UNIT : 746 | UNIT PRICE (MIN) RM288,888.00 (MAX) RM3,631,500.00. | BUILT-UP (MIN) 435 SQ.FT. - (MAX) 1356 SQ.FT. | BUMIPUTERA DISCOUNT : 15%

THE INFORMATION CONTAINED IN THIS BROCHURE IS SUBJECT TO CHANGE AND CANNOT FORM PART OF AN OFFER OR CONTRACT. ALL RENDERINGS ARE ARTIST'S IMPRESSIONS ONLY. ALL MEASUREMENTS ARE APPROXIMATE, WHILE EVERY REASONABLE CARE HAS BEEN TAKEN IN PREPARING THIS BROCHURE, THE DEVELOPER CANNOT BE HELD RESPONSIBLE FOR ANY INACCURACY. ALL THE ABOVE ITEMS ARE SUBJECT TO VARIATIONS, MODIFICATIONS & SUBSTITUTIONS AS MAY BE REQUIRED BY THE AUTHORITIES OR RECOMMENDED BY THE ARCHITECT OR ENGINEER.

exclusive waterfront living
play where you live

**THE
SHORE**
@ MALACCA RIVER

500 years of legend, culture and history have conspired to create a society unlike anything in Malaysia.

WELCOME

Here, the descendants of the Dutch, Portuguese and British have built homes and made their lives amongst the Javanese and Malays, Chinese and Indians... to create a delightful melting pot and an unforgettable location. From windmills to cathedrals, clock towers to exotic cuisine, Malacca today is a city of contrast and refinement. A city bestowed with UNESCO World Heritage status that you can now be a part of. At The Shore.



Artist impression of Tower 1

ENJOY

Dancing phoenixes adorn doorways, and sunlight streams down into open courtyards. Time-worn Dutch ceramic tiles bear silent witness to the passing years, while fertility rabbits are traced in glistening gold thread on lovingly hand-beaded slippers. A colourful mound of glistening ice in chipped China bowls, and in the air the smell of spices is a gentle reminder of a once-great port desired for its spice trade.

Over the centuries many have come to claim this exotic city, yet it is the city who has ultimately conquered them. Today, every street and every building is testament to centuries of life well lived.



THE MAP OF MALAYSIA



FAST FACTS

Nestled between Johor and Negeri Sembilan and cradled by the Straits of Malacca, the city of Malacca is located on the West Coast of Peninsular Malaysia.

This magical city of contrasts and modernity is just 147 kilometres from Kuala Lumpur, and a picturesque 90 minute drive via the North-South highway that links Alor Setar in the north, and Johor Bahru and Singapore in the south. Within this legendary state, The Shore is located away from the bustling tourist throngs yet near enough to revel in its historic air.

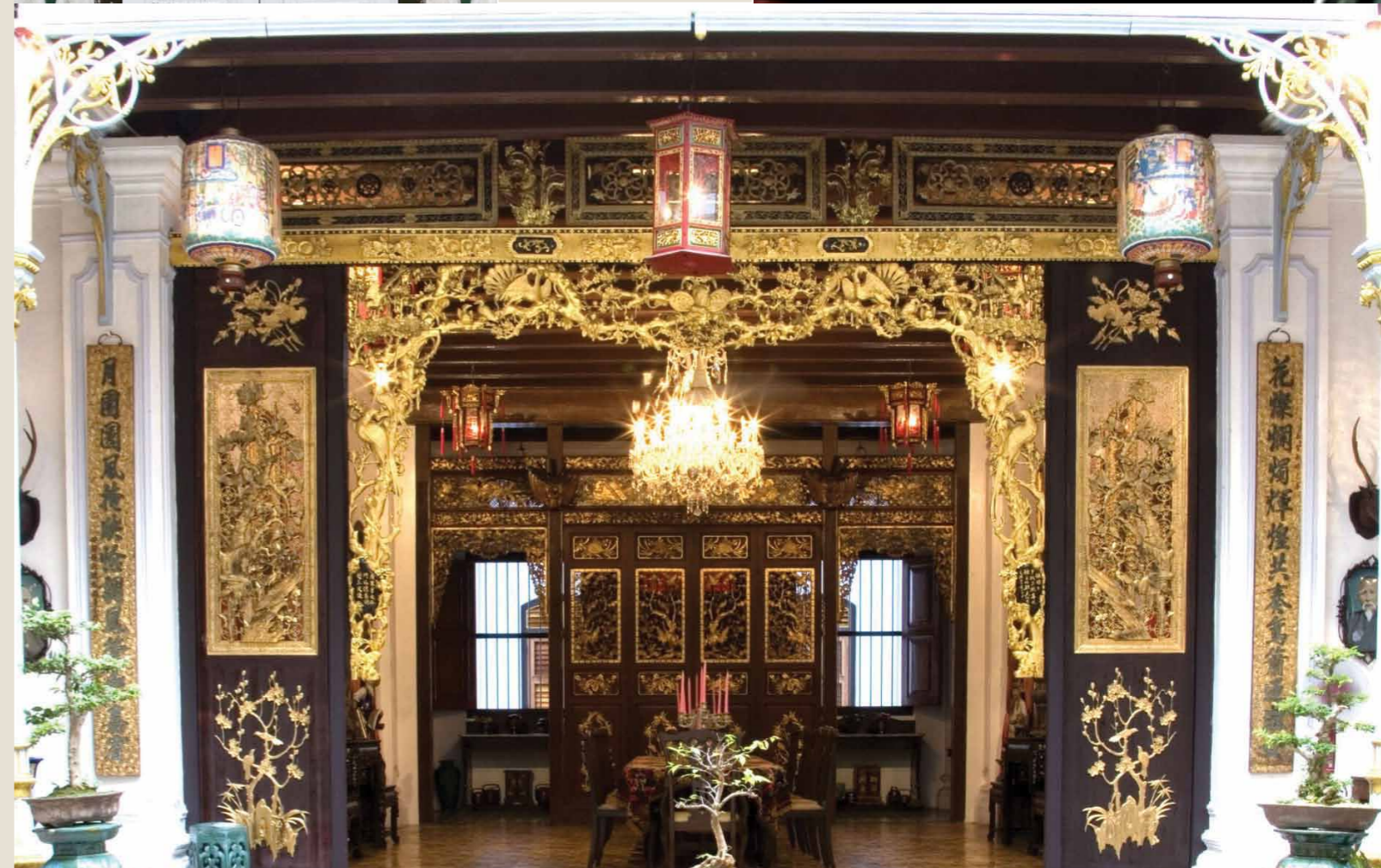



FAST FACTS

The Shore is a short drive away from the heart of Malacca's historical sites, the well-known Jonker Street and Chinatown. And a little farther on, you'll find nature parks, theme parks, animal farms, hill resorts, golf courses and even an island getaway. Local and international schools, private healthcare and commercial centres are also conveniently located.



EXPLORE

The Shore is graced by the sinuous Malacca river, and sits on an elevated ground by the shores of the Straits of Malacca. As befits a great trading empire of yore, Malacca is today a haven for shoppers with big city conveniences jostling for shelf space with centuries-old antiques and traditional crafts. The Shore is minutes away from these creature comforts of modern-day living.

LEGEND

- UNESCO WORLD Heritage Zone
- River Cruise Route (Connecting to Jonker St.)
- Proposed River Cruise Jetty
- Monorail Track (Hang Jebat Station - Hang Tuah Station - Proposed Tun Ali Station)
- Proposed Bridge





FAST FACTS

On an ample 3.1 acre site footprint, The Shore aims to create a self-contained community of discerning individuals. Extensive tropical landscaping throughout the development creates a sense of tropical idyll, where sun decks and cascading water features abound. On the bottom podium of 4 towers, a lifestyle shopping mall with three levels of retail and F&B outlets will meet the needs of the residents, and attract tourists as well as Malacca residents.

A 306-room Hotel with 4-Star facilities including a Business Centre, 1000-seater Banquet Hall, Seminar Rooms and Concierge services managed by the established Swiss-Garden International Hotels, Resorts & Inns will further add value to the development.



EXPRESSION

The Shore is a freehold, luxury mixed development that houses within its grounds 3 towers of luxury serviced residences, a 4-star hotel, and a lifestyle shopping mall with F&B outlets.

The architectural concept behind the entire development is a contemporary interpretation of rich Malaccan heritage, with a distinct nod to Peranakan influences. The open courtyards and ventilated fins of traditional Peranakan houses forming a distinct influence in the architect's vision of "free mobility". And throughout the development, Herman Salih's interpretation of Nyonya heritage through modern art reaffirms the relevance of Malacca in modern day living.



Artist impression of Hotel Tower



OVERALL MASTERPLAN



The Babas and Nyonyas rank family as one of the most important factors in life. Likewise, these values and beliefs have inspired the creation of The Shore. You'll see in the facilities that support the residences, and in the layout of individual residences. By incorporating these values into daily life at The Shore, the developers have turned brick and mortar residences into homes.

HOME

Home is where the heart is.
And heart is something
The Shore certainly
doesn't lack.

JOY

The reassurance of 24-hour security you receive at the grand entrance and its guardhouse, is slowly replaced by a deep sense of joy as you drive past a lush water feature and pull up to the beautifully landscaped lobby. Here, the calming sound of water is the perfect accompaniment to the tropical foliage and a reminder that you have truly come home.



Artist impression of Drop Off



Artist impression of Lobby

COMFORT

The Babas and Nyonyas of yore elevated leisure pursuits to a fine art with their Cherki games, Joget dances and melodious Dondang Sayangs. Life at The Shore promises to be similarly entertaining.

Housed on the 9th floor of The Shore Tower 1, the facilities deck incorporates extensive tropical landscaping into their leisure pool. And overlooking this serenity, is a fully equipped Sky Gym. A children's pool, swimming pool, lazy jacuzzi, omni court and nursery complete the creature comforts of the luxury residences.

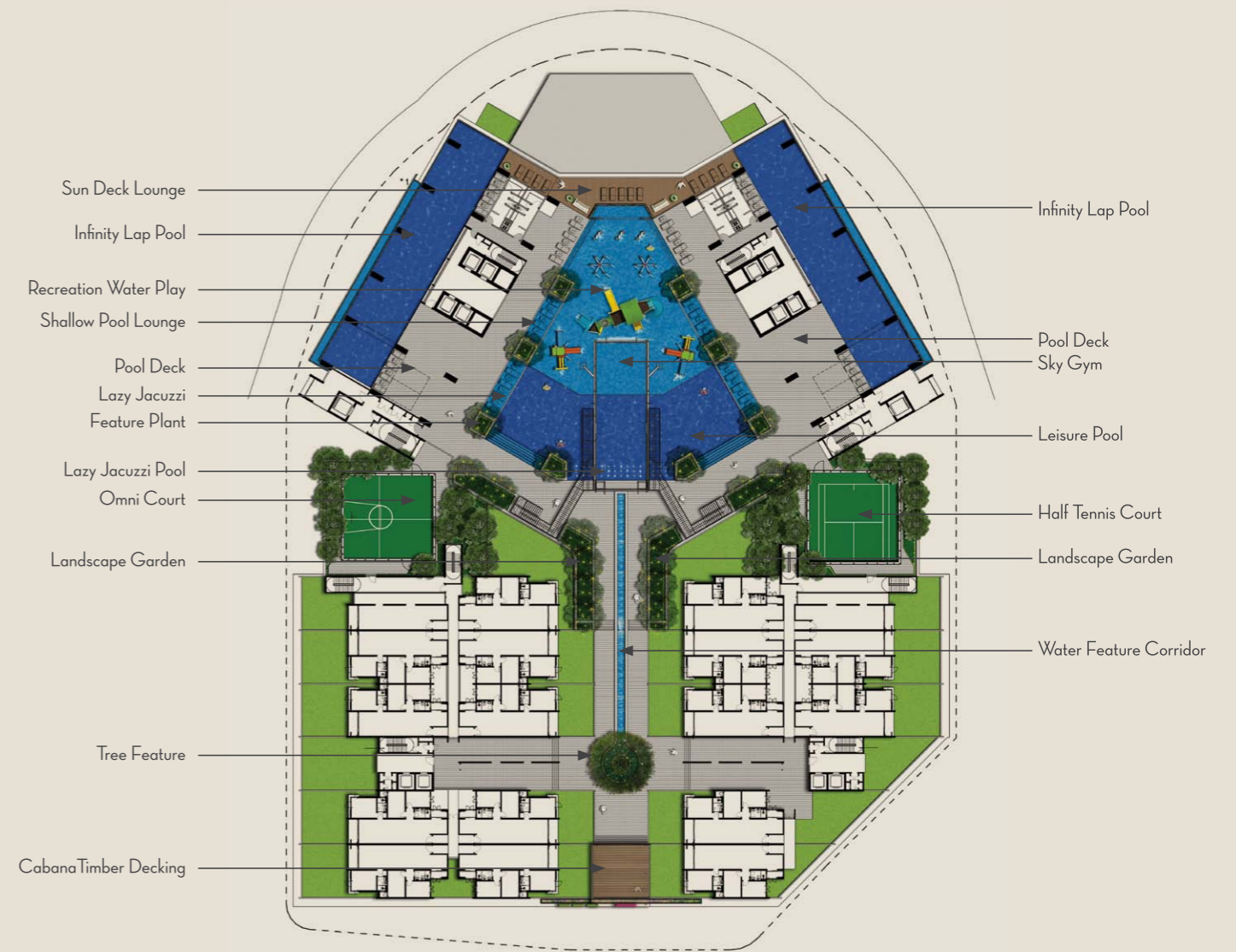

Artist impression of Sky Gym



Artist impression of Leisure Pool





Artist impression of Sky Lounge

LIVE & LOVE

The architectural concept behind The Shore is a contemporary interpretation of rich Malaccan heritage, with a distinct nod to Peranakan influences. The open courtyards and ventilated fins of traditional Peranakan houses forming a distinct influence in the architect's vision of "free mobility". And throughout the development, Herman Salih's interpretation of Nyonya heritage through modern art reaffirms the relevance of Malacca in modern day living. This contemporary Peranakan influence continues seamlessly into the interior design of each of the 392 units.





Here, the extensive use of glass, coupled with the minimal use of pillars, maximize the flow of light and energy. While the sweeping floor to ceiling windows offer stunning views of the straits, and ample balconies function as elegant entertainment and viewing galleries.